

Shaft diameter 12~20  
**D series**  
Quiet type

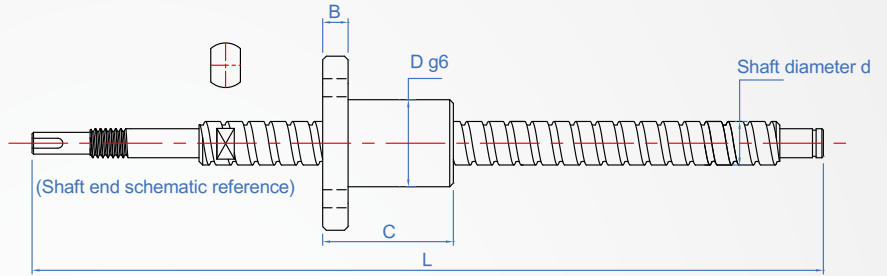

Precision	screw	Shaft hardness		Nuts	
		Material	Hardness	Material	Hardness
C7	Transformation grade	S55C	Tempered Fire (HRC60)	SCM415H	Tempering (HRC60)
C5	Grinding grade				

■ 1210、2010 (4 locking holes)  
■ 1520 (4 locking holes)

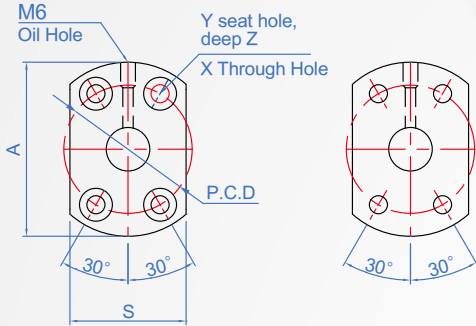

■ Quiet Nut Features/Construction  
Specially designed recirculation device to provide smooth operation of steel balls during fast movement and reduce noise value.

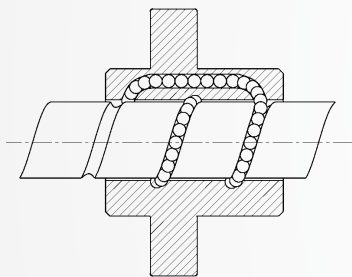

■ Lead accuracy (JIS B 1192) Unit : mm

Accuracy level	C7	C10
Cumulative lead time error	±0.05/300	±0.21/300

Tolerance of the accumulated lead error (±Ec) and variation (e) of the base lead for an arbitrary 300mm effective thread

■ Axial standard clearance Unit : mm

Shaft diameter	Axial clearance(max)
12	0.05
15~20	0.10

**How to order**

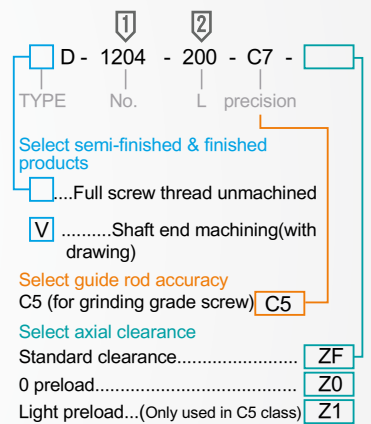

No.	d Guide	Guide	L Designation 1mm	A	B	C	D	S	P.C.D	X	Y	Z	Ball Diameter	Basic load (kgf)	
														Ca(Move)	Ca(Quiet)
														kN	kN
1210	12	10	100 ~ 800	50	10	40	30	32	40	4.5	8	4.5	2	390	466
1520	15	20	150 ~ 1000	55	12	57	34	34	45	6	—	—	3.175	833	997
2010	20	10	200 ~ 1500	74	13	54	46	46	59	6.6	11	5.5	3.969	1765	2338

Copyright © CHENA INDUSTRIAL CO.,LTD ALL Rights Reserved.