

Steel ball latch

**NB616**

T-shaped

Knob	Color	Pin	Steel ball
Zinc alloy	Black	SUS	SUS
SUS	True color		

Spring: SUS piano wire

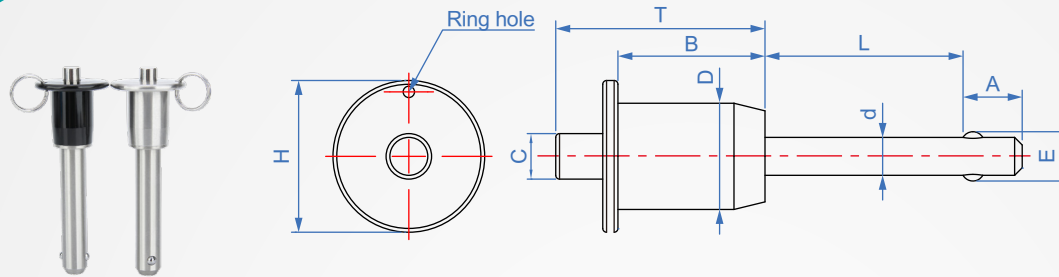

How to order

1  
 2  
 NB616 - 5 - 15 -   
 TYPE      d      L  
 Select Knob Material  
 Zinc alloy.....   
 Stainless steel.....  SUS

1											2											unit : mm	
d	E		Specified length L										C	D	H	B	T	A	Corresponding Hole Suggested Size	Shear force (KN)			
$\begin{matrix} -0.04 \\ -0.08 \end{matrix}$																		$\begin{matrix} +0.5 \\ -0 \end{matrix}$	$\begin{matrix} \pm 0.2 \end{matrix}$				
5	5.5	10	15	20	25	30											5	+0.06	24				
6	7	10	15	20	25	30	35	40	45	50							6	0	35				
8	9.5			20	25	30	35	40	45	50							8		63				
10	12			20	25	30	35	40	45	50	55	60	65	70			9		100				
12	14.5			25	30	35	40	45	50	55	60	65	70				10	+0.08	144				
14	16.5			25	30	35	40	45	50	55	60	65	70	80			11	0	200				
16	19			25	30	35	40	45	50	55	60	65	70	80	100		14		257				

\*L size length can be customized