

Shaft diameter 14~80  
**W series**  
Barrel with thread

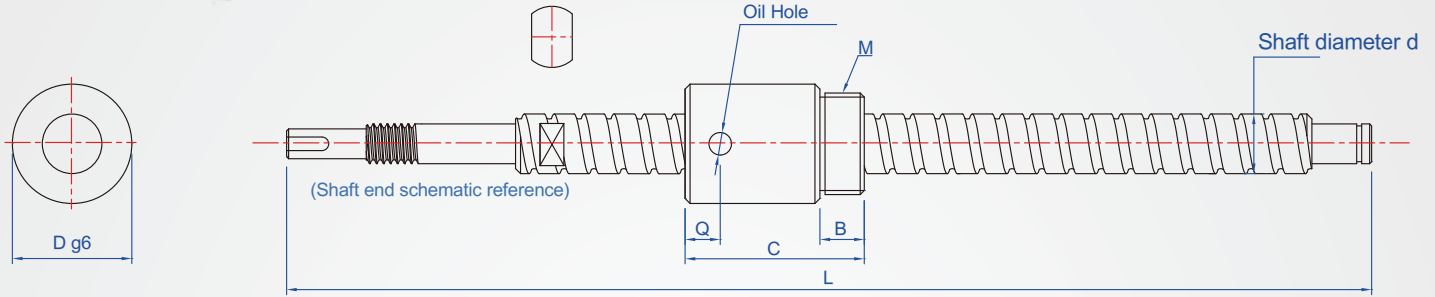

Precision	screw	Shaft hardness		Nuts	
		Material	Hardness	Material	Hardness
C7	Transformation grade	S55C	Tempered Fire (HRC60)	SCM415H	Tempering (HRC60)
C5	Grinding grade				



Lead accuracy (JIS B 1192) Unit : mm

Accuracy level	C7	C10
Cumulative lead time error	±0.05/300	±0.21/300

Tolerance of the accumulated lead error (±Ec) and variation (e) of the base lead for an arbitrary 300mm effective thread

Axial standard clearance Unit : mm

Shaft diameter	Axial clearance(max)
8~12	0.05
14~28	0.10
30~32	0.14
36~45	0.17
50	0.20

Inner loop features/construction

The outer diameter of the nut is lighter, suitable for machines with small internal space

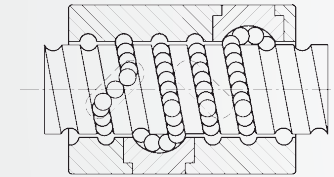

### How to order

W - 08025 - 200 - C7 -

TYPE No. L precision

Select semi-finished & finished products

...Full screw thread unmachined

.....Shaft end machining(with drawing)

Select guide rod accuracy C5 (for grinding grade screw)

Select axial clearance

Standard clearance..... ZF

0 preload..... Z0

Light preload...(Only used in C5 class) Z1

No.	Shaft diameter d	d Guide	L Designation 1mm	M	B	C	D	Ball Diameter	Q	Oil Hole	Basic load (kgf)	
											Ca(Move) kN	Ca(Quiet) kN
08025	8	2.5	100 ~ 400	M15 x1.0	8	26	17.5	1.2	—	—	215	239
1003	10	3	100 ~ 600	M18 x1.0	9	29	21	1.8	—	—	403	424
1204	12	4	100 ~ 800	M20 x1.0	10	34	25.5	2.381	—	—	645	693
1205		5										
1604	16	4	120 ~ 1200	M22 x1.5	8	32	29	2.381	—	—	737	940
1605		5		M30 x1.5	16	56	32	3.175	6.5	M6	1344	1525
2005	20	5	200 ~ 1500	M35 x1.5	16.5	59.5	38	3.175	7		1512	1995
2505	25	10	250 ~ 1500	M40 x1.5	17	60	42	4.762	10		2881	3695
2510										90		
3205	32	5	400 ~ 2000	M48 x1.5	19	60	52	3.175	7	M6	1924	3403
3210		10										
4005	40	5	300 ~ 2000	M56 x1.5	19	59	58	3.175	6	M8	2142	4342
4010		10		M60 x2.0	27	102	65	6.35	12			
5010	50	10	500 ~ 3000	M72 x2.0	29	104	78			6.35	12	5933

Copyright © CHENA INDUSTRIAL CO.,LTD ALL RIGHTS RESERVED.