

MX
MX234 Extended type

Outer tube	Steel ball	Holder	Ambient temperature	Annex
SUJ2 HRC58~	SUJ2	Resin	-20~80°C	Two side dust cover

characteristic : With lubricating resin, it has auxiliary maintenance function during exercise.

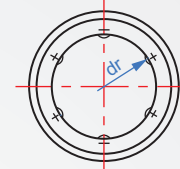
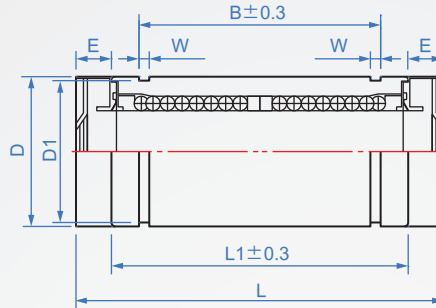
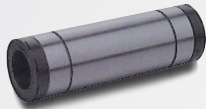

How to order

MX234 - 10L
TYPE dr

Main size and accuracy													Basic load rating			weight
dr	Tolerance	D	Tolerance	D1	L	L1	E	B	W	Number of steel ball columns	Eccentric max.	Move C(N)	Still Co(N)	(g)		
10L	+0 -0.010	19	+0 -0.016	18	65	55	5	44	1.3	4	0.015	588	1100	66		
12L		21		20	68	57	5.5	46				813	1570	84		
16L		28		27	82	70	6	53				1230	2350	152		
20L	+0 -0.012	32	+0 -0.019	30.5	94	80	7	61	1.6	5	0.020	1400	2740	191		
25L		40		38	130	112	9	82				1560	3140	459		
30L		45		43	143	123	10	89				2490	5490	504		
35L	+0 -0.015	52	+0 -0.022	49	157	135	11	99	1.85	6	0.025	2650	6270	823		
40L		60		57	175	151	12	121				3430	8040	1203		
50L		80		76.5	220	192	14	148				6080	15900	3163		

G6 tolerance guide is recommended.

1N≒0.12kgf