

Toothed idler

## DU300 S5M

Belt Width(mm)	10	15	20	25
Common size	A=11 W=16	A=17 W=22	A=22 W=27	A=27 W=32

Main Part	Flang	Finish	Code
aluminum alloy	aluminum	Clear anodizing	AS
		Black anodized	AB
		Electroless nickel	AK
		Hard anodized	AN
S45C	Iron	Byed black	TB
		Electroless Nickel	TN

**Y** Single bearing Retaining ring

**Z** Two bearing Retaining ring

Center bearing



Two side bearing

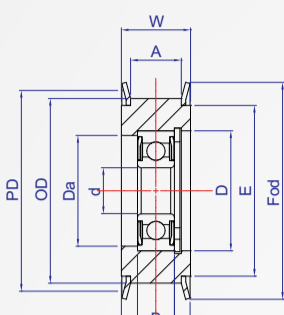

Single bearing

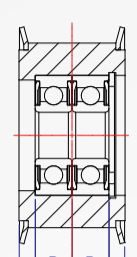

Two bearing

### How to order



- Choose a finish
- Aluminum + White Anodized..... **AS**
  - Aluminum + Black Anodized..... **AB**
  - Aluminum + hardened anode..... **AK**
  - Aluminum + Electroless Nickel..... **AN**
  - S45C+ dyed black..... **TB**
  - S45C+ Electroless Nickel..... **TN**

Unit : mm

Kind	Number of teeth	Tooth width	d	P.D	O.D	E	Fod	Y Single bearing					Z Two Bearing							
								No.	B	D	Da Max	e	C ring	No.	B	D	Da Max			
15	S5M-10 A=11 W=16	Y (Centered)	6	23.87	22.91	18	28	696ZZ	2pc	5	15	13.4	3	R15	606ZZ	2pc	6	17	15	
16				25.46	24.5	20	32	606ZZ	1pc	6	17	15	5	R17						
18			Z (Sides)	8	28.65	27.69	22.5	35	698ZZ	2pc	6	19	17	5	R19	698ZZ	2pc	6	19	17
20					31.83	30.87	24	40	628ZZ		8	24	22	4	R24					
22				35.01	34.05	28	40	628ZZ	8		24	22	4	R24	6900ZZ					
24				38.2	37.24	30	42	6000ZZ	8		26	24	4	R26						
25		Y (Centered)	10	39.79	38.83	30	45	6000ZZ	2pc	8	26	24	4	R26	6900ZZ	2pc	6	22	20	
26				41.38	40.42	34	47	6200ZZ		9	30	25	3.5	R30						
28			44.56	43.6	37	49	6200ZZ	1pc		10	32	27	3	R32						
30			47.75	46.79	40	52	6201ZZ													
32		50.93	49.79	40	55	6201ZZ	1pc	10	32	27	3	R32								
34		54.11	53.15	44	62	6201ZZ														
35		55.7	54.74	44	62	6201ZZ														
36		57.3	56.34	45	65	6201ZZ														
38		60.48	59.52	52.5	67.5	6202ZZ	1pc	11	35	30	5.5	R35								
40		63.66	62.7	52.5	67.5	6202ZZ														
42	66.85	65.89	59	73	6202ZZ															
44	70.03	69.07	59	73	6202ZZ															
18	S5M-15 A=17 W=22	Y (Centered)	8	28.65	27.69	22.5	32	698ZZ	2pc	6	19	17	5	R19	698ZZ	2pc	6	19	17	
20				31.83	30.87	24	35	628ZZ		8	24	22	3	R24						608ZZ
22			35.01	34.05	28	40	628ZZ	8		24	22	3	R24	6900ZZ						
24			38.2	37.24	30	42	6000ZZ	8		26	24	3	R26		6000ZZ					
25			39.79	38.83	30	45	6000ZZ	2pc		9	30	25	6.5	R30			6200ZZ			
26			41.38	40.42	34	47	6200ZZ													
28		44.56	43.6	37	49	6200ZZ														
30		47.75	46.79	40	52	6200ZZ														
32		50.93	49.97	40	55	6201ZZ	1pc	10	32	27	6	R32	6001ZZ							
34		54.11	53.15	44	62	6201ZZ														
35		55.7	54.74	44	62	6201ZZ														
36		57.3	56.34	45	65	6201ZZ														
38		60.48	59.52	52.5	67.5	6202ZZ	1pc	11	35	30	5.5	R35	6002ZZ							
40		63.66	62.7	52.5	67.5	6202ZZ														
42		66.85	65.89	59	73	6202ZZ														
44		70.03	69.07	59	73	6202ZZ														
18	S5M-20 A=22 W=27	Y (Centered)	8	28.65	27.69	22.5	32	698ZZ	2pc	6	19	17	7.5	R19	698ZZ	2pc	6	19	17	
20				31.83	30.87	24	35	628ZZ		8	24	22	5.5	R24						608ZZ
22			35.01	34.05	28	40	628ZZ	8		24	22	5.5	R24	6900ZZ						
24			38.2	37.24	30	42	6000ZZ	8		26	24	5.5	R26		6000ZZ					
25			39.79	38.83	30	45	6000ZZ	2pc		9	30	25	4.5	R30			6200ZZ			
26			41.38	40.42	34	47	6200ZZ													
28		44.56	43.6	37	49	6200ZZ														
30		47.75	46.79	40	52	6200ZZ														
32		50.93	49.97	40	55	6201ZZ	1pc	10	32	27	3.5	R32	6201ZZ							
34		54.11	53.15	44	62	6201ZZ														
35		55.7	54.74	44	62	6201ZZ														
36		57.3	56.34	45	65	6201ZZ														
38		60.48	59.52	52.5	67.5	6302ZZ	1pc	13	42	36	7	R42	6202ZZ							
40		63.66	62.7	52.5	67.5	6302ZZ														
42		66.85	65.89	59	73	6302ZZ														
44		70.03	69.07	59	73	6302ZZ														
18	S5M-25 A=27 W=32	Z (Sides)	8	28.65	27.69	22.5	32	698ZZ	2pc	6	19	17	5	R19	698ZZ	2pc	6	19	17	
20				31.83	30.87	24	35	628ZZ		8	24	22	3	R24						608ZZ
22			35.01	34.05	28	40	628ZZ	8		24	22	3	R24	6900ZZ						
24			38.2	37.24	30	42	6000ZZ	8		26	24	3	R26		6000ZZ					
25			39.79	38.83	30	45	6000ZZ	2pc		9	30	25	4.5	R30			6200ZZ			
26			41.38	40.42	34	47	6200ZZ													
28		44.56	43.6	37	49	6200ZZ														
30		47.75	46.79	40	52	6200ZZ														
32		50.93	49.97	40	55	6201ZZ	2pc	10	32	27	3.5	R32	6201ZZ							
34		54.11	53.15	44	62	6201ZZ														
35		55.7	54.74	44	62	6201ZZ														
36		57.3	56.34	45	65	6201ZZ														
38		60.48	59.52	52.5	67.5	6202ZZ	2pc	11	35	30	5	R35	6202ZZ							
40		63.66	62.7	52.5	67.5	6202ZZ														
42		66.85	65.89	59	73	6202ZZ														
44		70.03	69.07	59	73	6202ZZ														

\* 10mm: (15\*teeth) have two bearings °  
 \* 15mm: (18\*~25\*teeth) have two bearings °  
 \* 20mm: (18\*~35\*teeth) have two bearings °  
 \* 25mm: (18\*~44\*teeth) have two bearings °