

Shaft diameter 16~50

A series
Internal Circulation

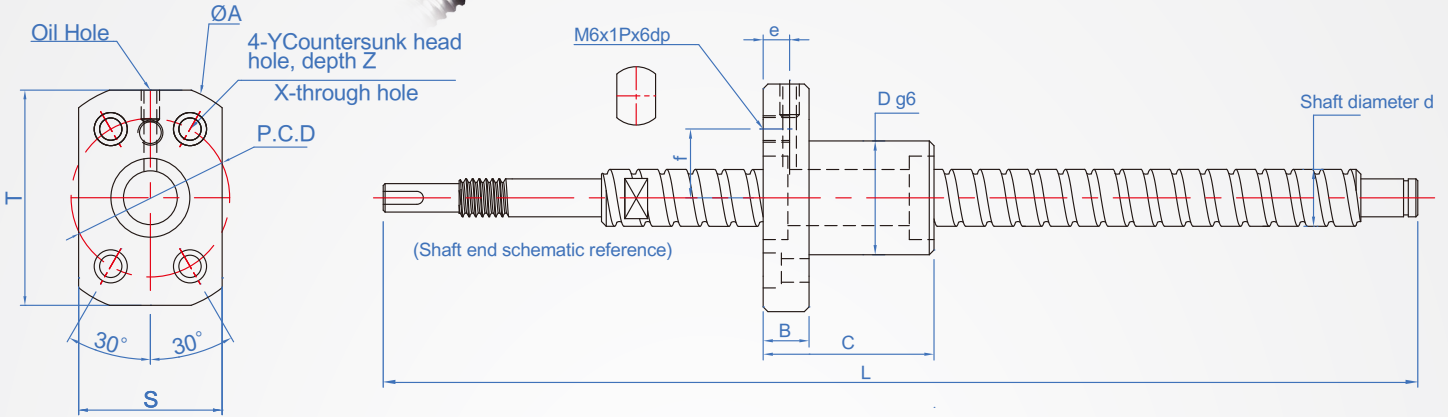

Precision	screw	Shaft hardness		Nuts	
		Material	Hardness	Material	Hardness
C7	Transformation grade	S55C	Tempered Fire (HRC60)	SCM415H	Tempering (HRC60)
C5	Grinding grade				



Inner loop features/construction

The outer diameter of the nut is lighter, suitable for machines with small internal space

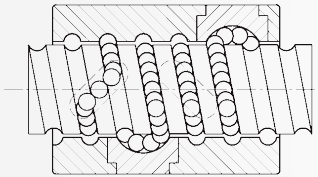

Lead accuracy (JIS B 1192) Unit : mm

Accuracy level	C7	C10
Cumulative lead time error	±0.05/300	±0.21/300

Tolerance of the accumulated lead error (±Ec) and variation (e) of the base lead for an arbitrary 300mm effective thread

Axial standard clearance Unit : mm

Shaft diameter	Axial clearance(max)
6~12	0.05
14~28	0.10

How to order

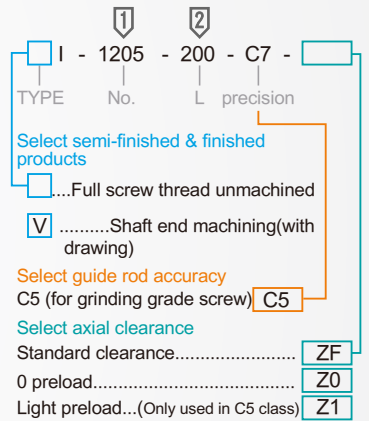

No.	d Guide	L Guide Designation 1mm	A	B	C	D g6	S	T	P.C.D	X	Y	Z	e	f	Ball Diameter	Oil Hole	Basic load (kgf)	
																	Ca(Move) kN	Ca(Quiet) kN
1205	12	5	50	10	43	30	32	45	40	4.5	8	4.4	6	15	2.000	M4	658	792
1210		10			50								7				522	698
1520	15	20	57	12	57	34	34	50	45	6	9.5	5.4	6	17	3.175	M6x1	833	997
1605	5	10		42	44												5.5	9.5
1610	16	10	11	11	44	44	44	60	55	5.5	11	6.5	6	22	3.175	M6x1	1181	1496
2005	5	20			48												44	44
2010	20	10	74	13	70	46	46	66	59	6.6	11	6.5	6.5	24	3.969	M6x1	1621	1925
2020		20			55												46	46

Copyright © CHENA INDUSTRIAL CO.,LTD ALL Rights Reserved.