

With female thread
S L684 Al alloy

L - tolerance : 60 within ± 0.1
 60 above ± 0.2

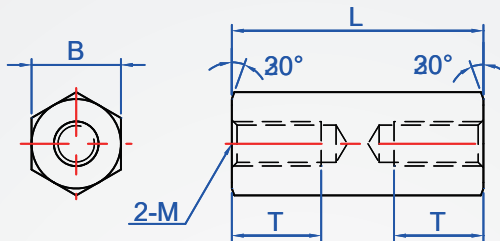

chamfer - 30°

Material	Finish
Al alloy (CB156)	Pickling
	Anodizing black

How to order

SL684 - 7 - M4 - 25 -

TYPE B M L

Finish chosen

Pickling.....

Anodizing black.....

B	M	Pitch	T	L		Unit : mm Preferential packaging
				1 mm	5 mm	
5.5	M3	0.5	6	16 ~ 30	35 ~ 100	50 pcs
7	M4	0.7	8	17 ~ 30	35 ~ 100	50 pcs

■ Short size : Full thread Unit : mm

B	M	L (指定1mm)
5.5	M3	4 ~ 15
7	M4	5 ~ 16