

Plum-shaped slider

GZ435

Wear-resistant clamping

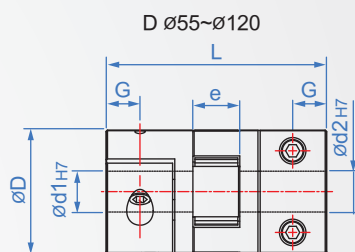
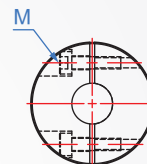
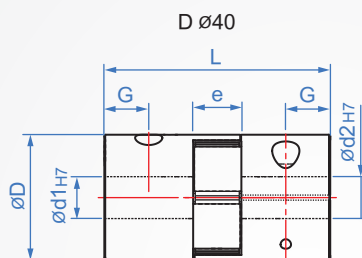
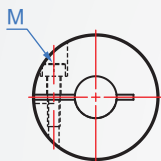
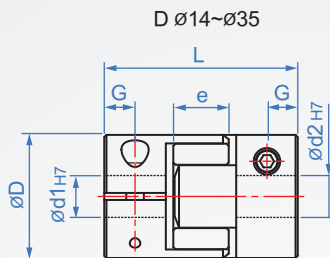
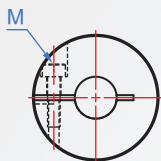

Ontology

AL
High strength aluminum alloy
(White anode)

SUS

Cushioning
material

PA66

Hexagon socket
head cap screwsCM435
(Dye black)

SUS

How to order

1 2 3
GZ435 - 20 - 30 - 3x5 -
TYPE D L d1xd2

Select the body material

AL-High strength aluminum alloy..
SUS..... SUS

1

2

3

unit : mm

| D | L | Inner hole designation d1-d2 min. max. | e | M | G | Max. torque (N · m) | | Max. return speed (rpm/min) | Moment of inertia (kg · m ²) | Static torsion spring coefficient (N · m/rad) | Allowable axial displacement (mm) | weight(g) | | | | | |
|------|-----|---|------|------|----------------------|------------------------|-----|-----------------------------------|--|--|--|-----------|------|----------------------|------|----------------------|------|
| | | | | | | AL | SUS | | | | | AL | SUS | | | | |
| 14 | 22 | 3 ~ 6 | 6.6 | M2.5 | 3.8 | 1.1 | 1.6 | 19000 | 2.0x10 ⁻⁷ | 46 | +0.6 0 | 10 | 25 | | | | |
| 20 S | 25 | 3 ~ 8 | 8.6 | M3 | 4.6 | 2.8 | 4.2 | 17000 | 1.0x10 ⁻⁶ | 55 | | 15 | 34 | | | | |
| 20 | 30 | 3 ~ 8 | | | 5.4 | | | | 1.1x10 ⁻⁶ | | | 19 | 43 | | | | |
| 25 S | 30 | 4 ~ 12 | 11.6 | M4 | 4.6 | 6 | 9 | 16000 | 5.2x10 ⁻⁶ | 65 | 33 | 68 | | | | | |
| 25 | 34 | 4 ~ 12 | | | 5.6 | | | | | | 42 | 75 | | | | | |
| 30 S | 35 | 5 ~ 16 | 10.9 | M4 | 5.9 | 6.5 | 9.8 | 12000 | 6.2x10 ⁻⁶ | 72 | 50 | 114 | | | | | |
| 30 | 40 | 5 ~ 16 | | | 7 | | | | | | 60 | 135 | | | | | |
| 35 | 50 | 5 ~ 19 | 11.5 | M5 | 6.5 | 15 | 21 | 10000 | 8.1x10 ⁻⁶ | 200 | +0.8 0 | 45 | 185 | | | | |
| 40 S | 50 | 6 ~ 24 | 6.7 | | 3.8x10 ⁻⁵ | | | | 450 | | | 115 | 220 | | | | |
| 40 | 55 | 6 ~ 24 | 7.2 | | 32 | | | | 48 | | | 127 | 289 | | | | |
| 40 H | 66 | 6 ~ 24 | 13.7 | M5 | 8 | 32 | 48 | 10000 | 3.9x10 ⁻⁵ | 550 | +0.8 0 | 154 | 380 | | | | |
| 55 | 49 | 12 ~ 32 | | | 6.5 | | | | 1200 | | | 241 | 490 | | | | |
| 55 H | 78 | 12 ~ 32 | 16.1 | M6 | 10.3 | 46 | 69 | 8000 | 1.6x10 ⁻³ | 1500 | 341 | 778 | | | | | |
| 65 | 90 | 14 ~ 40 | 16.7 | M8 | 11.9 | 109 | 164 | 6000 | 3.8x10 ⁻³ | 2800 | +1.0 0 | 583 | 1329 | | | | |
| 80 | 114 | 17 ~ 45 | 15.5 | | 135 | | | | | | | 200 | 4600 | 1.8x10 ⁻³ | 3500 | 1000 | 2280 |
| 95 | 126 | 19 ~ 55 | 24 | M10 | 15 | 250 | 350 | 3800 | 2.0x10 ⁻³ | 4600 | +1.0 0 | 1650 | 3300 | | | | |
| 105 | 140 | 20 ~ 60 | 21 | | 420 | | | | | | | 580 | 3400 | 3.2x10 ⁻³ | 5400 | 2640 | 5200 |
| 120 | 160 | 22 ~ 65 | 27.4 | | M12 | | | | | | | 26 | 520 | 730 | 3000 | 4.5x10 ⁻³ | 6500 |

Allowable declination:1°