

Shaft diameter 12~63

T series

Cylindrical keyway



Precision	screw	Shaft hardness		Nuts	
		Material	Hardness	Material	Hardness
C7	Transformation grade	S55C	Tempered Fire (HRC60)	SCM415H	Tempering (HRC60)
C5	Grinding grade				

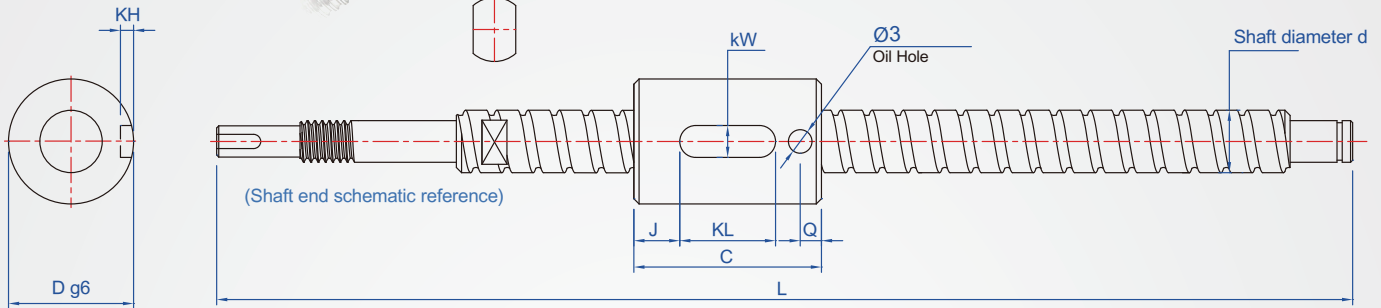

■ Lead accuracy (JIS B 1192) Unit : mm

Accuracy level	C7	C10
Cumulative lead time error	±0.05/300	±0.21/300

Tolerance of the accumulated lead error ($\pm Ec$) and variation (e) of the base lead for an arbitrary 300mm effective thread

■ Axial standard clearance Unit : mm

Shaft diameter	Axial clearance(max)
12	0.05
14~28	0.10
30~32	0.14
36~45	0.17
50~63	0.20

■ Inner loop features/construction

The outer diameter of the nut is lighter, suitable for machines with small internal space

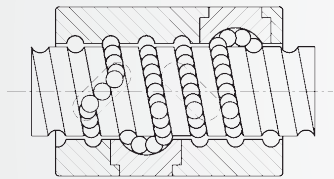

How to order

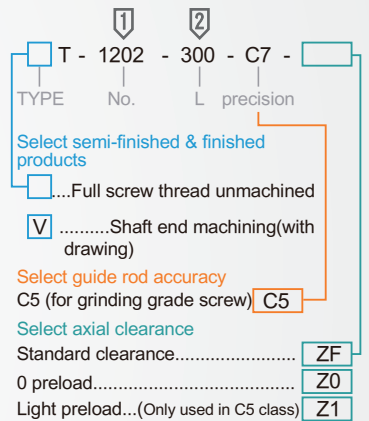

No.	Shaft diameter d	d Guide	L Designation 1mm	C	D	J	Keyway dimensions			Ball Diameter	Q	Basic load (kgf)	
							KW	KH	KL			Ca(Move) kN	Ca(Quiet) kN
1202	12	2	100 ~ 800	30	24	9	3	1.5	12	1.2	4	265	377
1204		4		11.5		2.381						645	693
1205		5		14		2						514	594
1210		10		17		3.969						390	466
1602	16	2	120 ~ 1200	40	28	10	5	2	20	1.2	5	300	503
1604		4		12.5		2.381						944	1254
1605-A		5		15		1049						1144	
1605-B		5		15		1344						1525	
1610		10		17.5		1181						1496	
1616		16		17		833						997	
2005-A	20	5	200 ~ 1500	47	36	13.5	5	2	20	3.175	7	1181	1496
2005-B		5		16.5		1512						1995	
2006		6		17		1568						1787	
2010		10		17.5		1765						2338	
2020	20	17.5	1659	2464									
2505	25	5	250 ~ 1500	53	40	16.5	5	2	20	3.175	7	1704	2581
2510		10		17		1614						2460	
3205	32	5	300 ~ 2000	53	50	11.5	6	2.5	30	3.175	7	1924	3403
3210		10		20		6.35						3775	5877
3220		20		24		3.969						2141	3576
4005		5		13		3.175						2142	4342
4010	40	10	400 ~ 2000	80	63	25	6	2.5	30	6.35	7	4216	7556
4020		20		16.5		5.556						3782	6468
5010	50	10	500 ~ 3000	82	75	23	6	2.5	30	6.35	14	4633	9235
6310	63	10		90	85	29						3.5	32