

## Round steel short GN412 Clamping

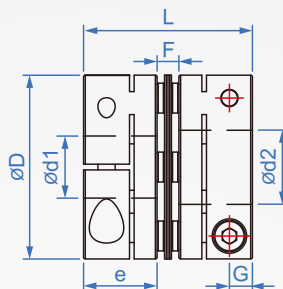
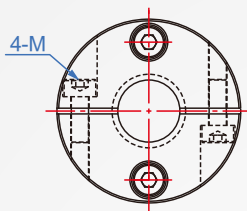

Ontology	Disc.Pin	Hexagon socket head cap screws
AL aluminum alloy (White anode)	stainless steel	SCM435 (Dye black)
SUS		SUS

### How to order

GN412 - 28 - 5-10

TYPE      D      d1xd2

Select the body material

AL-High strength aluminum alloy...

SUS.....

D	Inner hole designation d1-d2		L	e	G	F	M	Max. torque (N · m)		Allow eccentricity (mm)	Max. revolutions (rpm/min)	Moment of inertia (kg · m <sup>2</sup> )		Static torsion spring coefficient (N · m/rad)		Allowable axial displacement (mm)	Allowable declination (°)	weight g	
	min.	max.						AL	SUS			AL	SUS	AL	SUS			AL	SUS
16	3	~ 6	16.5	7.35	2.5	1.8	M2	0.6	1	0.5	15000	9.8x10 <sup>-8</sup>	2.3x10 <sup>-7</sup>	300	500	±0.1	0.5°	8	15
19	3	~ 8	20	9	3.3		M2.5	1	1.5			2.9x10 <sup>-7</sup>	7.4x10 <sup>-7</sup>	600	1000			13	29
25	3	~ 12	24	10.5	3.9	2.6	M3	2	3	1	10000	1.1x10 <sup>-6</sup>	2.8x10 <sup>-6</sup>	1300	1500	±0.2	1°	25	53
28	3	~ 12	28	12.5				2.2	3.3			1.4x10 <sup>-6</sup>	3.8x10 <sup>-6</sup>	1600	2100			34	67
32	3	~ 16	29	12.75	5	4.5	M4	4.2	6.3	1	10000	4x10 <sup>-6</sup>	1.1x10 <sup>-6</sup>	2500	1800	±0.3	1°	57	115
40	8	~ 19	33	14.25				8	12			9.8x10 <sup>-6</sup>	2.3x10 <sup>-5</sup>	4600	3800			86	185
50	8	~ 24	42	18.75	6.4	5.5	M5	15	15	1	10000	1.6x10 <sup>-5</sup>	3.9x10 <sup>-5</sup>	6000	5500	±0.4	1°	130	305
55	10	~ 32	45	19.75				25	37			5.7x10 <sup>-5</sup>	1.4x10 <sup>-4</sup>	14000	7000			201	513

unit : mm