

夾鉗用配件  
**GH999-□**

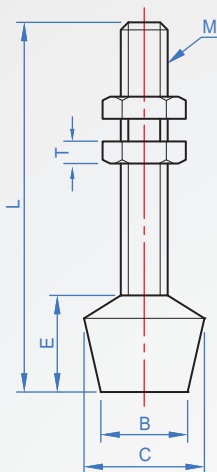

A：膠頭



B：活動頭

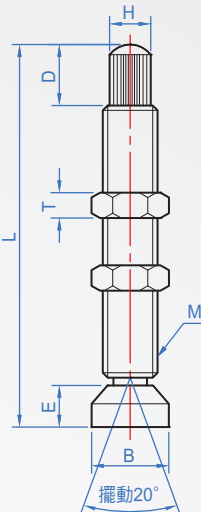

外型	本體	頭部
A	鋼 (鍍鋅)	NBR(合成橡膠) 蕭氏A70
B	鋼 (鍍銅)	可擺動20°

How to order

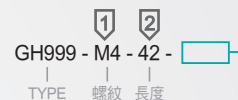

選擇外型

膠頭.....  A  
活動頭.....  B



版權所有重製必究

外型	M	Pitch	L	B	E	T	S	C	D	H		
A (膠頭)	M4	0.7	25、42	8	10	3.2	7	12	-	-		
	M6	1.0	44、51	10	14	5	10	16				
	M8	1.25	63、75	12	18.5	6.5	13	19				
	M10	1.5	85	16	25	8	17	24				
	M12	1.75	100	22	26	10	19	32				
	10-24	-	35	11	11	1/8"	3/8"	14				
	1/4-20		45、54	10	12	7/32"	7/16"	16				
	5/16-18		64、76	12	18	17/64"	1/2"	18				
	3/8-16		89、114	14	25.5	21/64"	9/16"	22				
	1/2-13		95	24	26	7/16"	3/4"	30				
B (活動頭)	M5	0.8	35	12	10	4	8	-	-	-		
	M6	1.0	50			5	10					
	M8	1.25	65			6	13					
	M10	1.5	85	20	15	8	17					
	M12	1.75	100			10	19					
	M16	2.0	152	45	30	13	24					
	1/4-20	-	57	13	9.5	7/32"	7/16"				8.5	4.8
	5/16-18		69	14	10	17/64"	1/2"				10	6
	3/8-16		77	16	11	21/64"	9/16"				13.8	7.2
	1/2-13		102	19	12	7/16"	3/4"				18.3	9.5